



Quick Installation Guide

Indoor/Outdoor Access Point

1 Overview

Package Contents

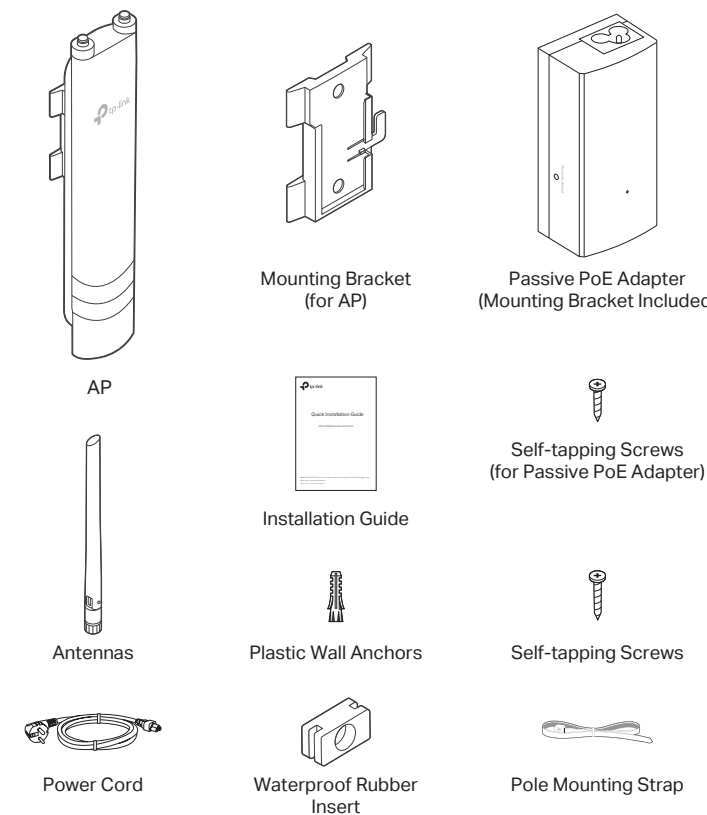

Note: Accessories may vary by product.

Panel Layout

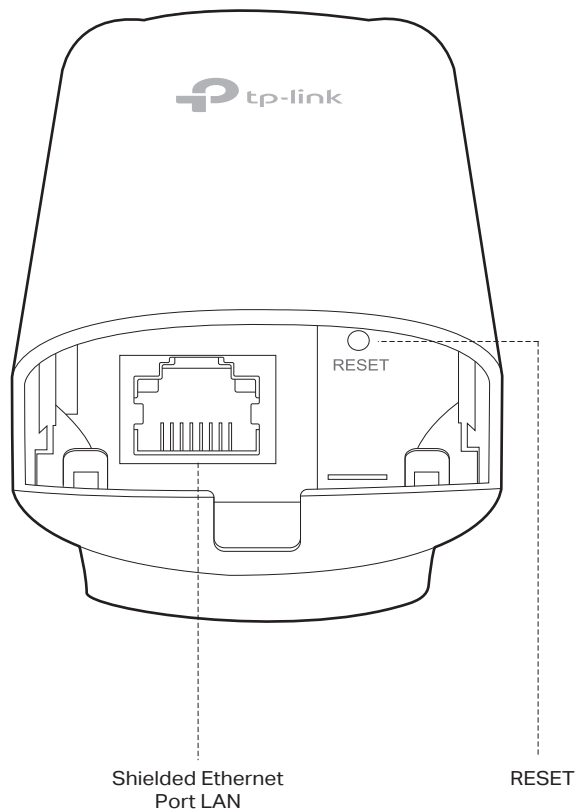

SYS LED Explanation

LED Status	Indication
Flashes green twice	Initialization is completed.
Solid green	The device is initializing or working properly.
Flashing yellow	System errors. RAM, Flash, Ethernet, WLAN or firmware may be malfunctioning.
Flashing yellow, green	Firmware update is in progress. Do not disconnect or power off the device.
Quickly flashing yellow, green	The device is being reset to its factory default settings.
Flashing green slowly (Only for Festa F52-Outdoor)	The device is in an isolated state.

Passive PoE Adapter

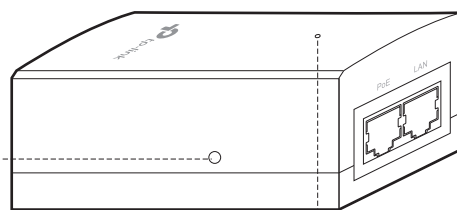

Remote Reset:
Press and hold for about 8 seconds until the LED is quickly flashing yellow then green. The AP will restore to factory default settings.

Power LED:
On: Power on
Off: Power off

Note: Festa F52-Outdoor does not support the Remote Reset feature.

2 Lightning and ESD Protection

Before mounting the AP, consider Lightning and ESD Protection to ensure safety.

Proper grounding is extremely important for outdoor devices. By using a shielded CAT5e (or above) cable for connection, you can reduce the damage of ESD attacks.

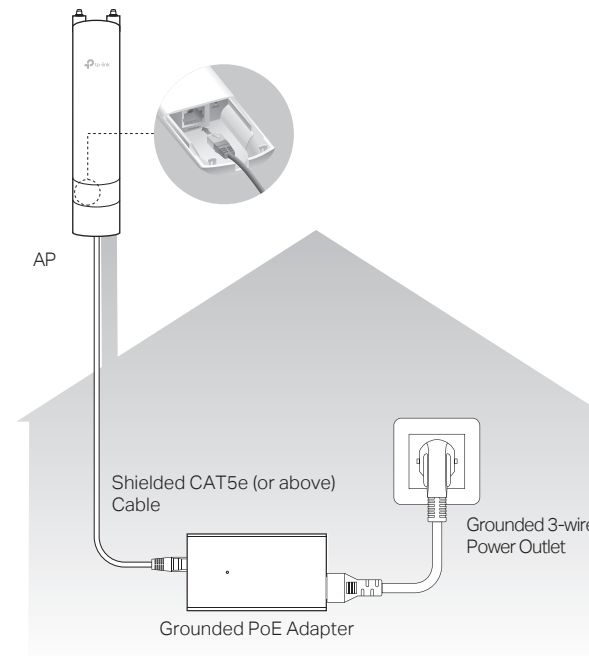

3 Hardware Installation

Mount the AP

The AP can be pole-mounted or wall-mounted. Follow the steps below for the appropriate installation.

Option 1: Pole Mounting

Step 1:

Lead the end of the pole mounting strap through the back of the AP.

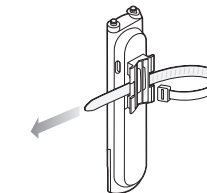

Step 2:

Position the AP and wrap the pole mounting strap around the pole. Feed the end through the screw-block and tighten the strap until the AP is secure.

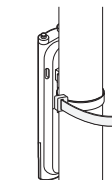

Step 3:

Connect the antennas to the AP. For optimal Wi-Fi performance, adjust the direction of the antennas. It is recommended to position the antennas at 45-degree angles.

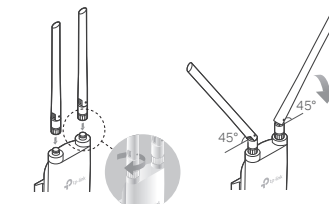

Option 2: Wall Mounting

Step 1:

Place the mounting bracket (for AP) in the right position. Mark two positions for the screw holes. Drill two holes for the screws at the marked positions.

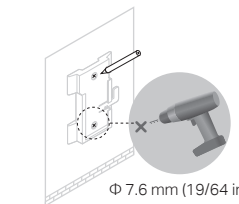

Step 2:

Insert the plastic wall anchors into the holes. Align the bracket (for AP) to the plastic wall anchors and drive the self-tapping screws into the anchors through the bracket (for AP).

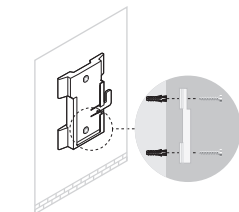

Step 3:

Align the mounting tabs on the back of the AP with the slot of the mounting bracket (for AP). Push and slide the AP downward until it locks into place.

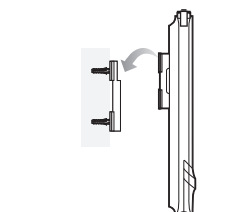

Step 4:

Connect the antennas to the AP. For optimal Wi-Fi performance, adjust the direction of the antennas. It is recommended to position the antennas at 45-degree angles.

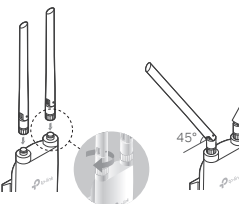

Note: Festa F52-Outdoor is used as an example throughout the Guide. Images may differ from your actual product.

©2024 TP-Link 7106511102 REV1.0.0

Connect Cables

Step 1:

Firmly grasp the rear of the interface cover and pull it downward.



Step 2:

Use an adequate Ethernet cable to connect the LAN port. The length of cable is up to 100 m for steady power supply. Shielded CAT5e (or above) cable is recommended.

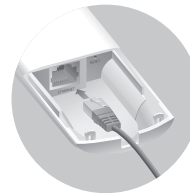

Step 3:

Attach the waterproof rubber insert to the groove at the underside of the device for waterproofing. Move the Ethernet cable to the hole of the waterproof rubber insert.

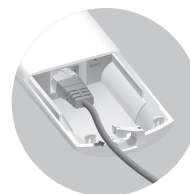

Step 4:

Flatten the waterproof rubber insert until it gets parallel to the device. Replace the cover until it firmly locks into place.

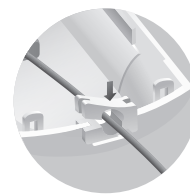

Power On

The AP can be powered via the passive PoE adapter or a PSE device (such as a PoE switch) which complies with Power Source Class 2 (PS2) or Limited Power Source (LPS) of IEC 62368-1.

Option 1: Via Passive PoE Adapter

Connecting the PoE Adapter

Connect the AP to a Power over Ethernet (PoE) adapter as follows:

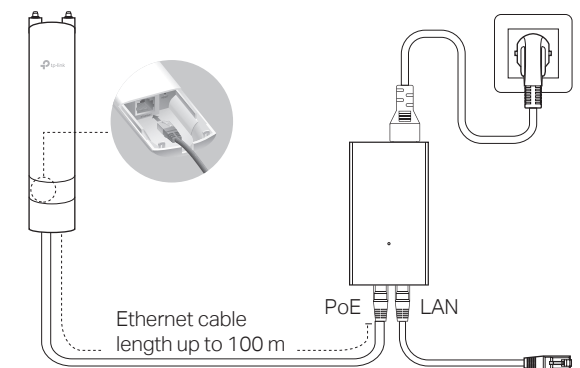

Mounting the PoE Adapter (Optional)

Note: To ensure the passive PoE adapter is attached most securely, it is recommended to install the adapter with the Ethernet port facing upward.

Step 1:

Remove the mounting bracket from the passive PoE Adapter. Drill two holes on the wall and insert the plastic wall anchors into the holes. Secure the mounting bracket to the wall. Make sure the shoulders at the corners of the mounting bracket are on the outside and pointing upward.

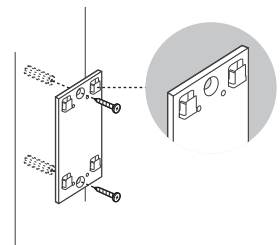

Step 2:

Attach the passive PoE adapter to the mounting bracket (for PoE Adapter) by sliding the adapter in the direction of the arrows until it locks into place.

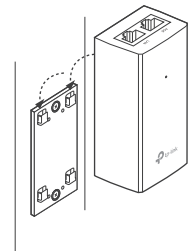

Option 2: Via PoE Switch

Note: Festa F41-Outdoor does not support this power option. Connect an Ethernet cable from the PoE switch to the Ethernet port.

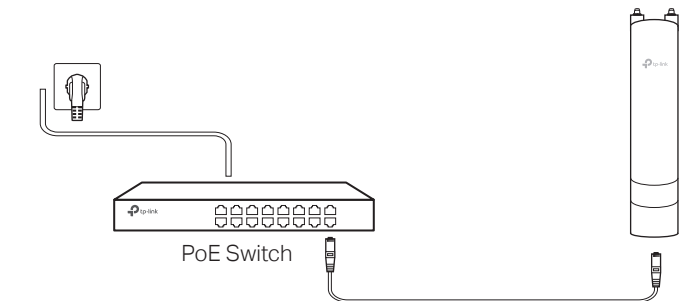

4 Software Configuration

You can configure and manage Festa APs via the Festa Cloud-Based Controller.

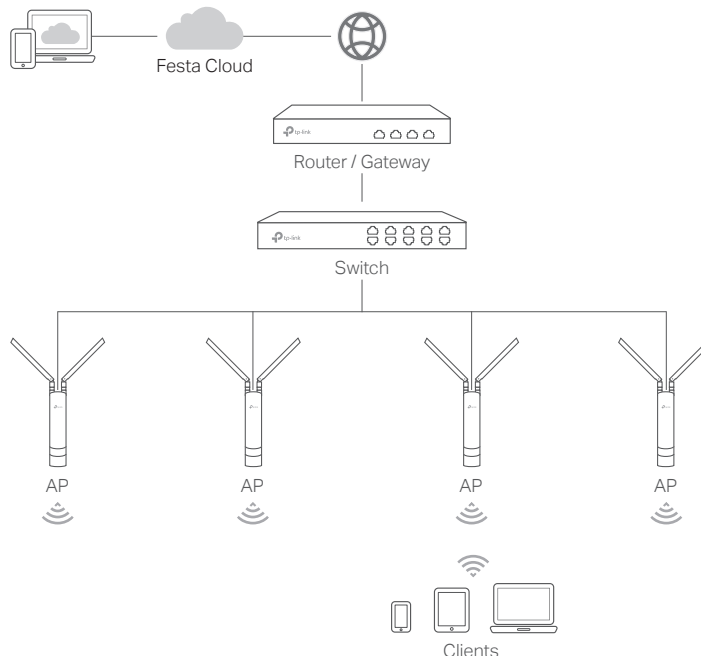

Option 1: Via Web Browser

1. Make sure that your management device can access the internet.
2. Launch a web browser and enter <https://festa.tplinkcloud.com> in the address bar. Log in with your TP-Link ID.



3. Click **+ Add Controller**, then you will see you have successfully registered for a Cloud-Based Controller and the controller has been added to the controller list.
4. Click **Set Up Now**, click **Config New Setup**, and follow the step-by-step instructions to complete the configuration wizard of the controller.
5. On the controller's management page, go to **Devices**, click **+ Add Devices**, and follow the step-by-step instructions to adopt Festa devices.

Now you can configure and manage Festa devices on the controller.

Option 2: Via Festa App

1. Download and install the Festa App from App Store or Google Play.

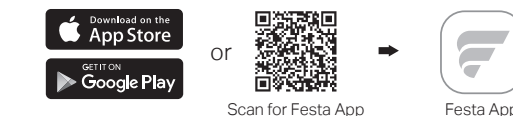

2. Launch the Festa App and log in with your TP-Link ID.
3. Tap **+** on the upper right corner, then you will see you have successfully registered for a Cloud-Based Controller and the controller has been added to the controller list.
4. Tap **Confirm**, tap **Let's Get Started**, and follow the step-by-step instructions to complete the configuration wizard of the controller.
5. On the controller's management page, go to **Devices**, click **+** on the upper right corner, and follow the step-by-step instructions to adopt Festa devices.

Now you can configure and manage Festa devices via the Festa App.

For detailed configurations, refer to the User Guide of the controller. The guide can be found on the download center of our official website: <https://www.tp-link.com/support/download/?type=smb>.

To ask questions, find answers, and communicate with TP-Link users or engineers, please visit <https://community.tp-link.com/business> to join TP-Link Community.

For technical support, the user guide and other information, please visit <https://www.tp-link.com/support/?type=smb>, or simply scan the QR code.



Safety Information

- Keep the device away from fire or hot environments. DO NOT immerse in water or any other liquid.
- Do not attempt to disassemble, repair, or modify the device. If you need service, please contact us.
- Do not use the device where wireless devices are not allowed.
- Do not use any other chargers than those recommended.
- Adapter shall be installed near the equipment and shall be easily accessible.
- Use only power supplies which are provided by manufacturer and in the original packing of this product. If you have any questions, please don't hesitate to contact us.
- Adapter should be used indoors where the ambient temperature is lower than or equal to 40°C.
- The plug on the power supply cord is used as the disconnect device, the socket-outlet shall be easily accessible.

TP-Link hereby declares that the device is in compliance with the essential requirements and other relevant provisions of directives 2014/53/EU, 2009/125/EC, 2011/65/EU and (EU)2015/863.

The original EU Declaration of Conformity may be found at <https://www.tp-link.com/en/support/ce/>

TP-Link hereby declares that the device is in compliance with the essential requirements and other relevant provisions of the Radio Equipment Regulations 2017. The original UK Declaration of Conformity may be found at <https://www.tp-link.com/support/ukca/>



Attention: In EU member states, EFTA countries and Northern Ireland, the operation in the frequency range 5150MHz-5350MHz is only permitted indoors.

Attention: In Great Britain, the operation in the frequency range 5150MHz - 5350MHz is only permitted indoors.

For Festa Controller, go to the **Devices** page and select the desired AP to specify the channel.

For web browser, go to **Wireless > Wireless Settings** to specify the channel.

	AT	BE	BG	CH	CY	CZ	DE	DK
	EE	EL	ES	FI	FR	HR	HU	IE
	IS	IT	LI	LT	LU	LV	MT	NL
	NO	PL	PT	RO	SE	SI	SK	UK(NI)

