

5 GHz 90° 4x4 Asymmetrical Horn Antenna

HIGH PERFORMANCE 4x4 HORN ANTENNA

This 5 GHz 4x4 Asymmetrical Beam antenna is designed for excellent performance with MU-MIMO radios, such as ePMP 3000 or ePMP 4500. 4x4 Antenna Array is based on Award Winning 90° Asymmetrical Horn Antenna elements. Overall radiation pattern is 90° wide in the azimuth plane and 25° in elevation.

Outstanding noise rejection and precision of the radiation pattern throughout the bandwidth of operation favor the antenna for high-density access point clusters and densely co-located sites. Antenna features RP-SMA female connectors and integrated mount of ePMP 3000 4x4 radio.



Asymmetrical Horn antennas were awarded WISPA Product of the Year 2019, 2020 and 2021 Awards.

TECHNICAL DATA

Radio Connection	2x2 RP-SMA Female Connector
Antenna Type	Horn
Materials	UV Resistant ABS Plastic, Polycarbonate, HDPE, Aluminium, Stainless Steel
Environmental	IP55
Pole Mounting Diameter	40-80 mm (1.5-3.1 inch) Recommended as close to 80 mm (3.1 inch) as possible
Temperature	-35°C to +60°C (-31°F to +140°F)
Wind Survival	160 km/h (100 mi/h)
Wind Load	173/93 N - Front/Side at 160 km/h (100 mi/h)*
Effective Projected Area	2252/754 cm ² - Front/Side (349.0/116.9 in ²)*
Mechanical Adjustment	± 20° Elevation
Weight	10.6 kg (23.3 lbs) – single unit* 14 kg (30.8 lbs) – single unit incl. package*
Single Unit	Retail Box: 485 × 420 × 396 mm (19 × 16.5 × 15.5 inch)*

PERFORMANCE

Frequency Range	5180 - 6000 MHz
Gain	16 dBi
Azimuth Beam Width -3 dB	H 60° / V 60°
Elevation Beam Width -3 dB	H 16° / V 16°
Azimuth Beam Width -6 dB	H 90° / V 90°
Elevation Beam Width -6 dB	H 25° / V 25°
Beam Efficiency**	90 %
Front-to-Back Ratio	30 dB
VSWR Max	1.8
Polarization	Dual Linear H + V

PRODUCT DIMENSIONS

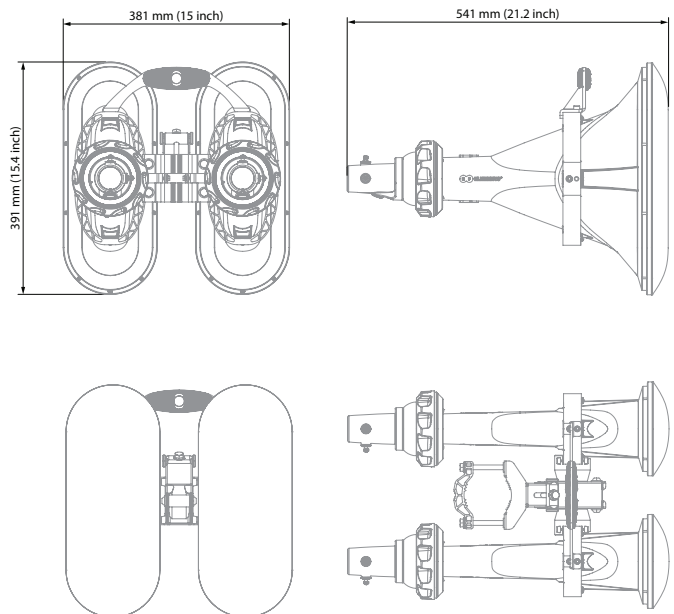

SINGLE CHANNEL AZIMUTH PATTERN



SINGLE CHANNEL ELEVATION PATTERN

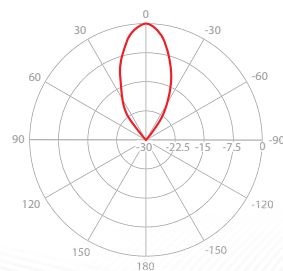

*Subject to change, **Main beam defined up to first null

GAIN

